

LINE VOLTAGE | UP LIGHT | A-CT4

Replacement Parts

ITEM	DESCRIPTION	CATALOG #
1, 3	Lens Cap Assembly, Std Shroud, Clear Lens	CST9LCXX*
2-3	Lens Cap Assembly, Long Shroud, Clear Lens	CST9LCLSXX*
1	Faceplate, Standard Shroud	†
2	Faceplate, Long Shroud (LS)	†
3	O-Ring	250010280000
4	Reflector, 20° SP	250025320000
4	Reflector, 40° SP	250025330000
4	Reflector, 60° SP	250025340000
5	Screw, 4-40 x 3/8"	762400
6	Reflector Adapter Ring	250022330000
7	LED Board	See LED Config Chart
8-15	Housing Assembly (SV, UV, and HV Power)	CST9HALNXX*
8	Main Housing	†
9-14	Mounting Kit Faceplate Assembly	†
13-15	Mounting Kit (SV, UV, and HV Power)	MKCT4
9	O-Ring	250010280004
10	Screw, 10-24 x 1/2"	250021490000
11	Driver Housing Top	†
12	Setscrew, 8-32 x 1/2"	†
13	Driver	See Driver Config Chart
14	Gasket	†
15	Driver Housing	†

* Replace "XX" with desired powder coat finish code

† This part is not serviceable. Contact Customer Support or a local distributor to order a new product.

Driver Configuration Chart

BASE	POWER CONTROL	OUTPUT
DVR	SV 120V/60Hz Phase UL Listed	500 1,000 Lumens
	UV 120-277V/60Hz 0-10V Dim (UL)	700 700 Lumens (L07) & 1,300 Lumens (L13)
	HV 220-240V/50Hz 0-10V CE Certified	700D SV L13 Only

Example: **DVRUV500**

LINE VOLTAGE | UP LIGHT | A-CT4

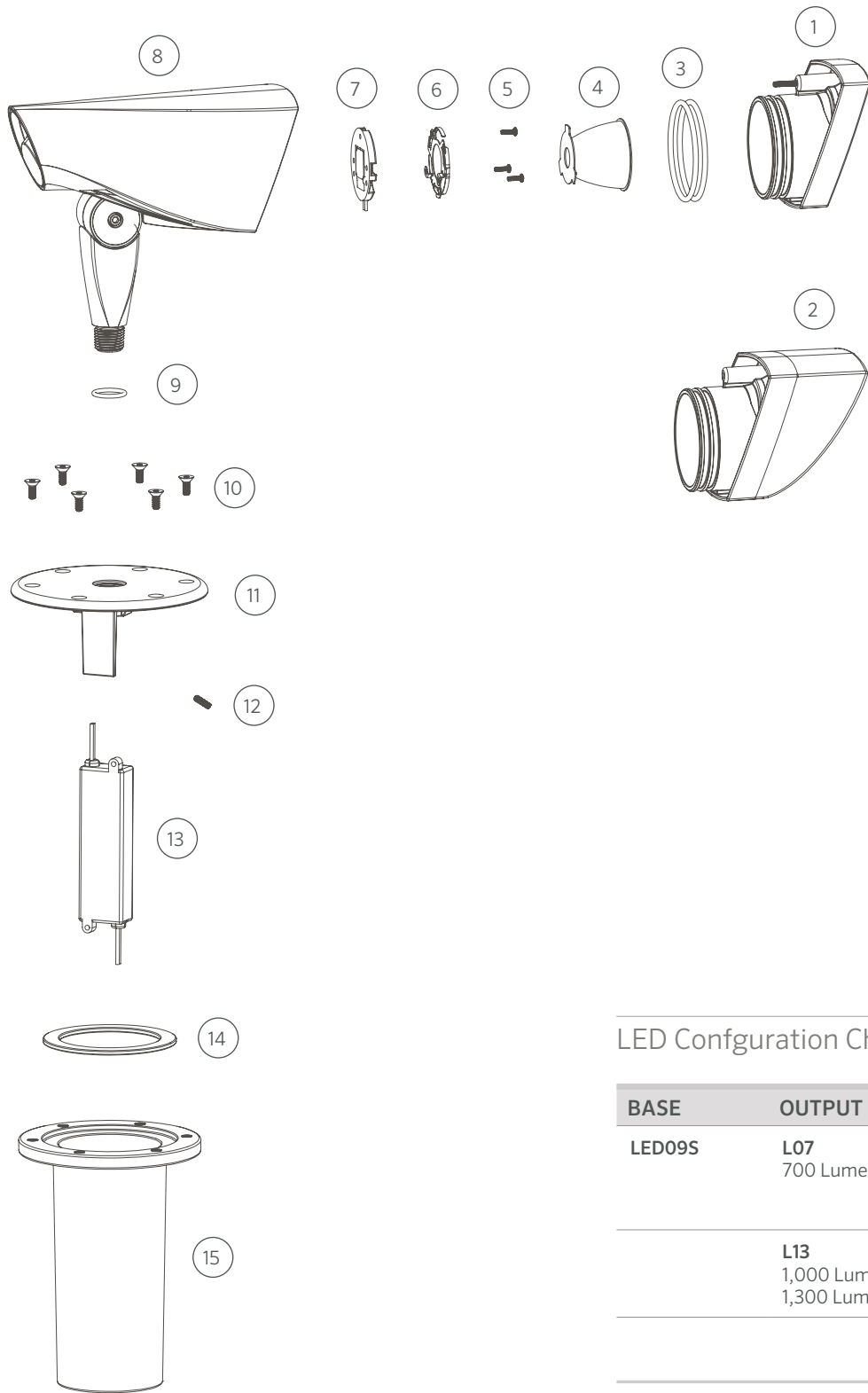

LED Configuration Chart

BASE	OUTPUT	CCT
LED09S	L07 700 Lumens (L07)	K27 2,700K
	L13 1,000 Lumens (L10) & 1,300 Lumens (L13)	K30 3,000K
		K40 4,000K

Example: LED09SL07K30